

With these machines we have saved: size, not technology!

A Safe Future with MultiSolvent®

Also with the 12 to 18 kg capacity 6th Generation machines we no longer differentiate between hydrocarbon and other alternative solvents. The new small MultiSolvent® machines are suitable for all class A III chlorine-free solvents with a flash point greater than 55°C and that are lighter than water (e.g. HC or cyclosiloxanes like GreenEarth®). By simply changing software settings, all functions and processes are adjusted to the solvent chosen.

So, you can see your future and your investment are safe with the new BÖWE MultiSolvent® machines.

BÖWE MultiSolvent® = High-tech MultiSolvent®

With BÖWE MultiSolvent® machines you can be sure of the best quality. Specially perfected process technology ensures the machines are optimally adjusted to all relevant solvents.



Avoids creation of odor: the water separator system



BÖWE has also cracked the problem with biodegradable solvents that has got others stymied: creation of odor.

In order to best separate water resp. low-boiling liquids from the solvents and thus practically eliminate creation of odor, a fractional still and an automatic multistep water separator are absolutely necessary. It goes without saying that these features are standard with all BÖWE MultiSolvent® machines.

The Multi-Purpose-Design

The M12, M15, and M18 were designed to exactly meet your needs also with regards to space. There are two ways to have your machine installed - slimline or crossline - whatever your shop dictates. Slimline: here, the still is located behind the machine. Crossline: the still is set up at the side of the machine. All that with an entry height of less than 2000 mm.

**SuperDry
PDS+**

Power Drying System

Especially when cleaning with high-boiling solvents, drying of the garments is of utmost importance. The BÖWE Power Drying System has been further optimized by the new aerodynamic recovery section in the 6th Generation. With this system you will achieve excellent drying results and unbeatably short cycle times. You will also notice the impact of gentle drying on cleaning results and the feel of garments, which will make ironing easier.

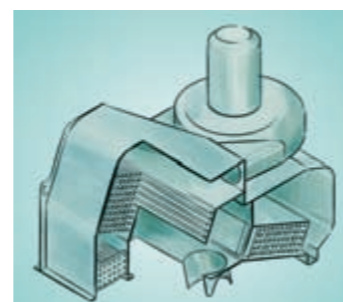

The aerodynamic recovery section

Self-Cleaning Solvent Tanks

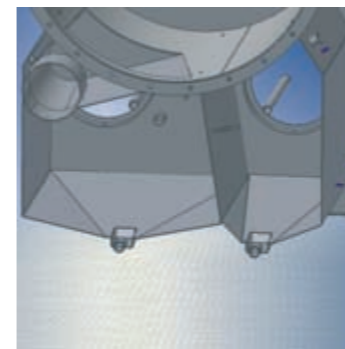

No deposit - Self-cleaning

Comfort with Cleaning of the Machine

Cleaning intervals for the filter are unusually extended, due to the especially large proven lint filters. The three standard tanks and water separator are self-cleaning. Optionally, the machines are also available with a second filter.



Needs to be cleaned only once a day: the lint filter

High-Capacity Control ConfoTronic PL

The ConfoTronic PL offers a variety of possibilities for individual adjustment to various tasks and guarantees a safe, efficient, and variable operation of the machine.

The control can easily be updated by reading from a standard MMC or SD card.

Maintenance Made easy with IMS (Interactive Maintenance System)

IMS - what does that mean? These are automatic maintenance programs, as well as two additional multi-maintenance programs, that bundle maintenance steps and intelligently have them run simultaneously. The machine shows when maintenance is required and certain maintenance cycles like e.g. filter maintenance are performed without any manual interference. However, you do not have to worry about losing control over your machine. The machine only provides suggestions, but you certainly decide when maintenance is performed.



Easy-to-operate to the smallest detail

Variable Speed Drive and EBS®

We have increased the extraction speed of the MultiSolvent® machines. Extraction is now done at a speed of up to 600 rpm as a standard. The BÖWE M12/15/18 MultiSolvent® machines are equipped with a variable speed drive and EBS® (Electronic Balancing System) as standard, so imbalances during extraction are avoided electronically. You can perform

extraction without any problems, even if the machine is not fully loaded. The variable speed drive with its infinitely variable speed control provides for a gentle cleaning cycle that can be individually adjusted for any type of garments.

Safety

In order to guarantee safety even with potentially flammable hydrocarbon solvents, multiple independent safety arrangements are designed into all BÖWE MultiSolvent® machines. These safety devices guarantee 100 % safety, even if several unfavorable events should coincide.

The MultiSolvent®-Machines

Performance

- > Compact design
- > Aerodynamic recovery section
- > Power Drying System, SuperDry PDS+
- > High extraction speed up to 600 rpm
- > Variable speed drive and EBS®
- > Solvent cooling via refrigeration technology
- > Drystat
- > Fractional distillation
- > Load level sensors (high and low level)
- > Solvent safety trough
- > All important components made of stainless steel
- > Selection of various filter systems *

Comfort

- > ConfoTronic PL
- > IMS (Interactive Maintenance System)
- > 2 self-cleaning water separators
- > 3 self-cleaning solvent tanks
- > Direct Connect
- > Large maintenance openings
- > Clear operating display
- > Empty soap drum alert *

*Option

The 6th Generation

M12
M15
M18



MultiSolvent® – with loading capacities
from as small as 12 kg

PremiumLine



BÖWE
Textile Cleaning



Highly efficient
fractional still



Easily viewed from a distance: the
large display remaining cycle time

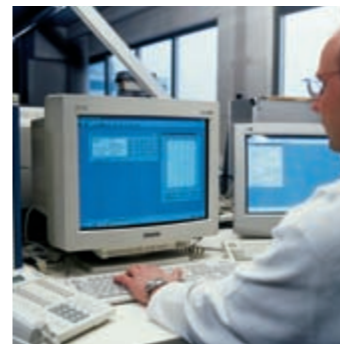

With BÖWE Direct Connect
remote maintenance is possible

BÖWE Textile Cleaning GmbH
Dr.-Georg-Schaeffler-Str. 22
77815 Bühl
Germany
Tel. +49 (0) 7223 80103-0
Fax +49 (0) 7223 80103-29
info@boewe-tc.de
www.boewe-tc.de

BÖWE
Textile Cleaning

Excellence in Drycleaning: The MultiSolvent®-Machines in Detail

	M12	M15	M18	
Solvent	Hydrocarbon solvents			
	Cyclosiloxanes (e.g. GreenEarth®)			
Cage				
Loading capacity	kg	12	15	18
Cage volume	l	240	300	360
Cage diameter	mm	820	820	820
Cage depth	mm	460	570	680
Cleaning speed	rpm	40	40	40
Extraction speed, max.	rpm	600	600	600
Low level	l	30	37,5	45
High level	l	60	75	90
Tank (loading capacity)				
Tank I	l	110	130	155
Tank II	l	70	85	100
Tank III	l	90	90	90
Extraction filter	l	40	40	40
Still	l	120	120	120
Machine measurements (with safety trough)				
Width (slim-/crossline)	mm	1,080/1,840	1,080/1,840	1,080/1,840
Depth (slim-/crossline)	mm	2,165/1,410	2,165/1,410	2,275/1,540
Height	mm	2,260	2,260	2,260
Surface (slim-/crossline)	m ²	2.3/2.5	2.3/2.5	2.4/2.6
Entry measurements				
Width (slimline)	mm	930	930	930
Height	mm	1,995	1,995	1,995
Weight ** (slim-/crossline)	kg	1,140/1,240	1,240/1,340	1,340/1,440

** optional with 2 extraction filters and 1 cartridge filter

Subject to technical changes and errors.



Your BÖWE Partner